

DELBROUCK

Ribbeck
...denn verpacken ist nicht alles

 **G. MONDINI** S.p.A.
DOSATRICI - CONFEZIONATRICI AUTOMATICHE

Sealed Cover - Multi-Function-Crate

A Step Forward towards Design without Limits

Sealed Cover

Application of a film sealed onto a crate*

- For special campaigns, sales promotions or brands eg.
- Covering the print or the windows of the crate



Film on the short side of a crate

* Patents with Delbrouck GmbH

Added Value for the Crate



Application of a Film over the Windows

- The crate can still be used without the film.
- The sealing does not damage the crate.



Sealed Cover,

a technique primarily for one circulation of the crate but also possible for many circulations.

Film in Every Shape

- A form with a special outline

Inclined shape to allow the bottle recognition for display crates eg.

- To be printed on in flexo print



Film in Every Shape (1)



Film in Every Shape (2)



Film in Every Shape (3)

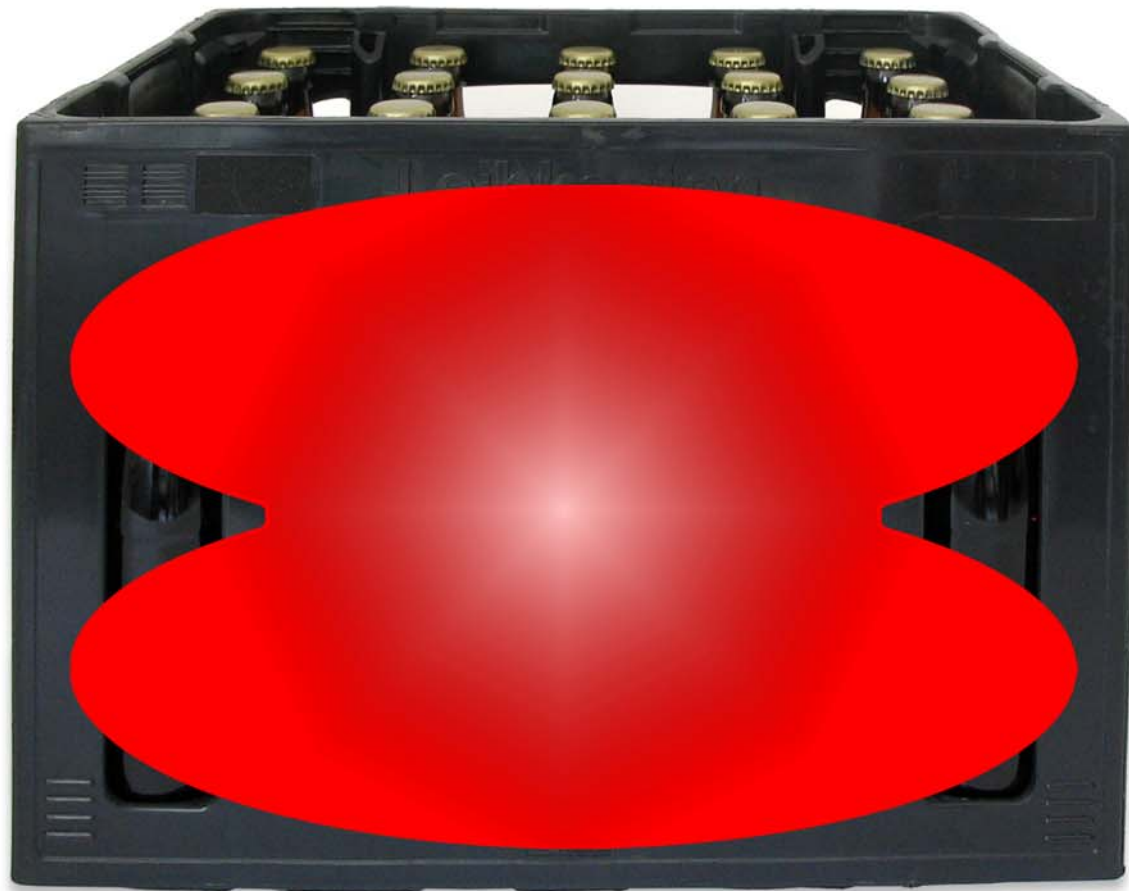

Film in Every Colour



- Printing of the film with shining colours or metal effects
- Transparent or opaque
- The film provides additional UV protection

Film in Every Colour (1)



Film in Every Colour (2)



Film in Every Colour (3)



Labeling of the Crate on the Film

- Tagging through EAN
- Possibility to apply an RFID (one-way transponder) give-aways (flat) collection points etc.
- Possibility to use printers for individual tagging from front or back



Secure Traceability of the Crate

Construction and Material of the Laminate Film

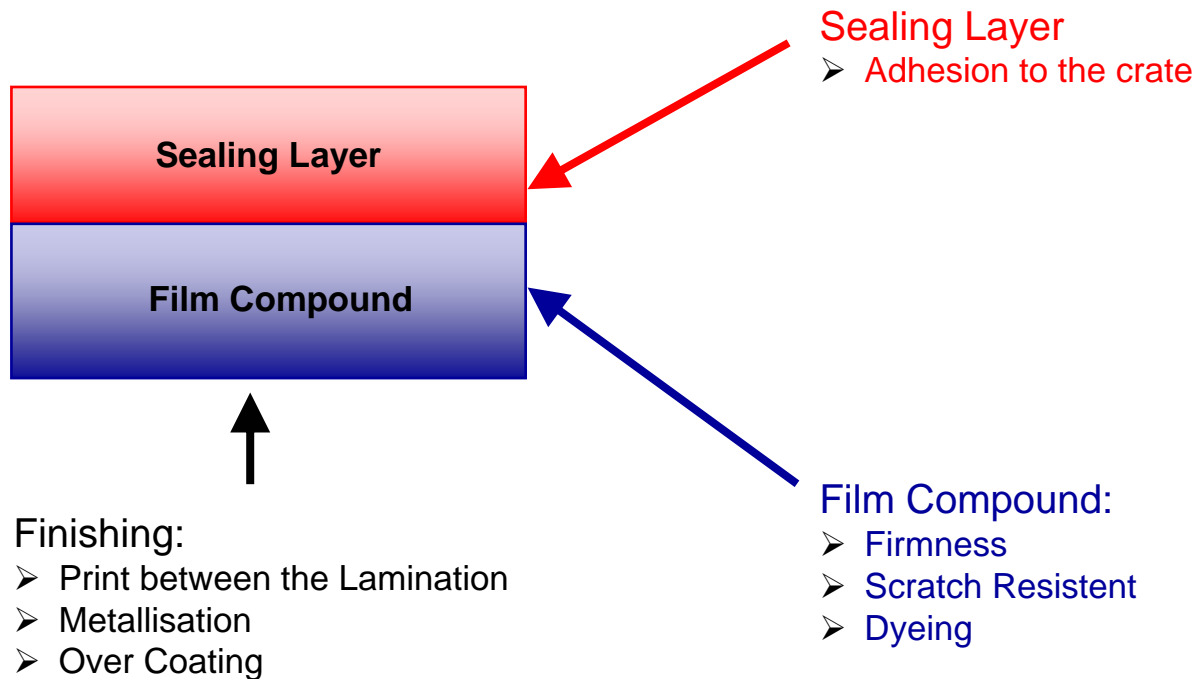

Easy to Apply – Residue-Free to Remove

Detail of the crate corner with the sealing rip for the exact application of the film

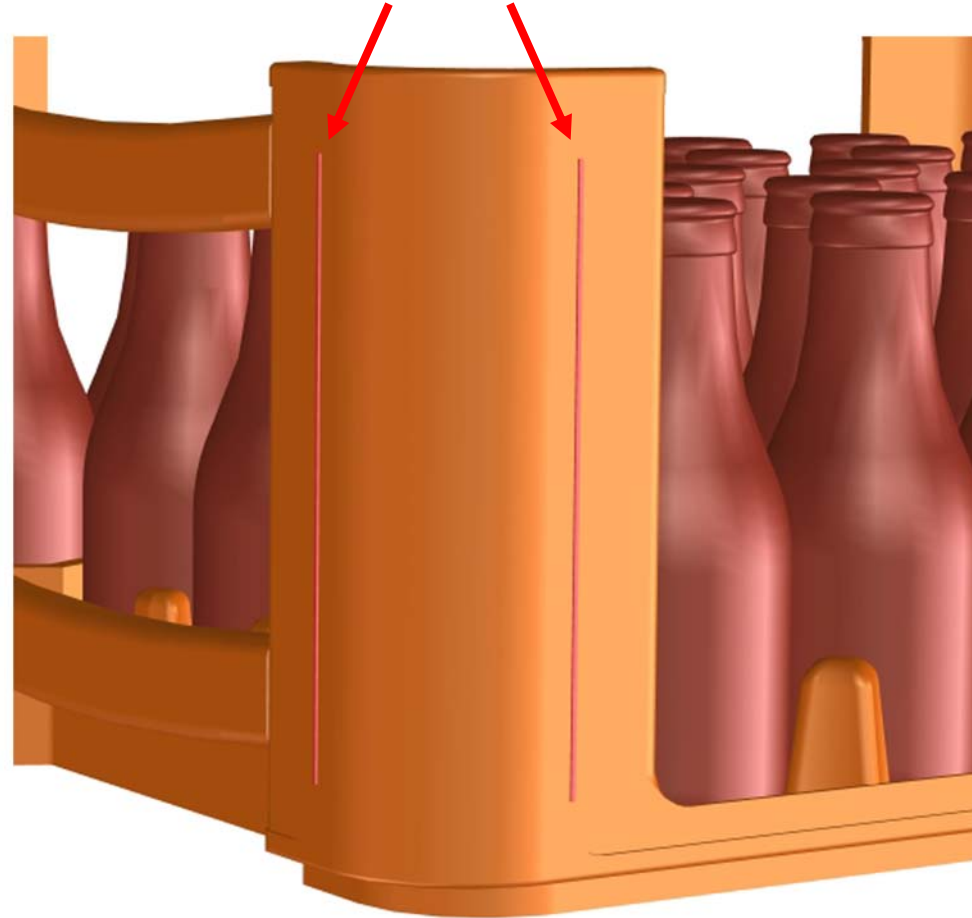

Example for a Transparent Film

Perforation of the film to allow the consumer to access the handle of the crate

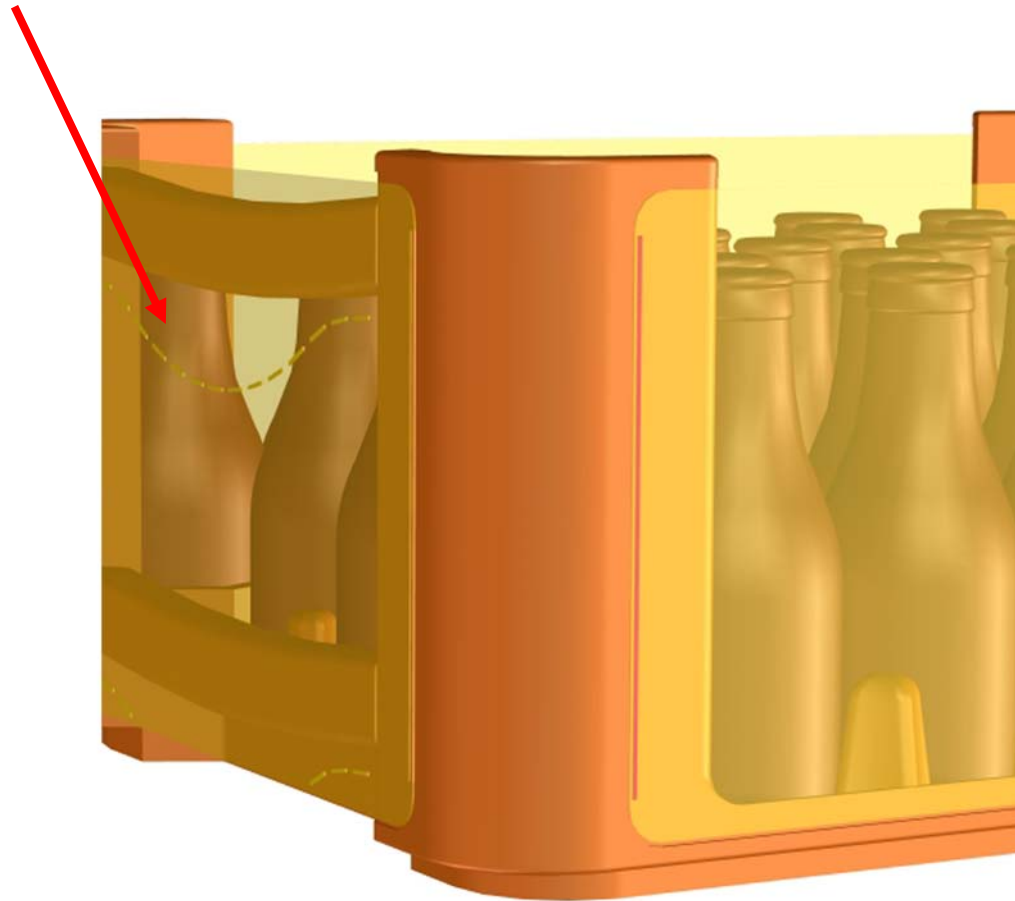

The Machine for Applying the Film

- Machine in a bridge construction, flexibly designed for crates of sizes up to 300x400x300 mm
- Printed film on rolls
- Completely variable system: a new tool per shape of the film, including cutter and sealing plate
- Easy change of film rolls and tools
- Performance: 12 films per min (double sided)

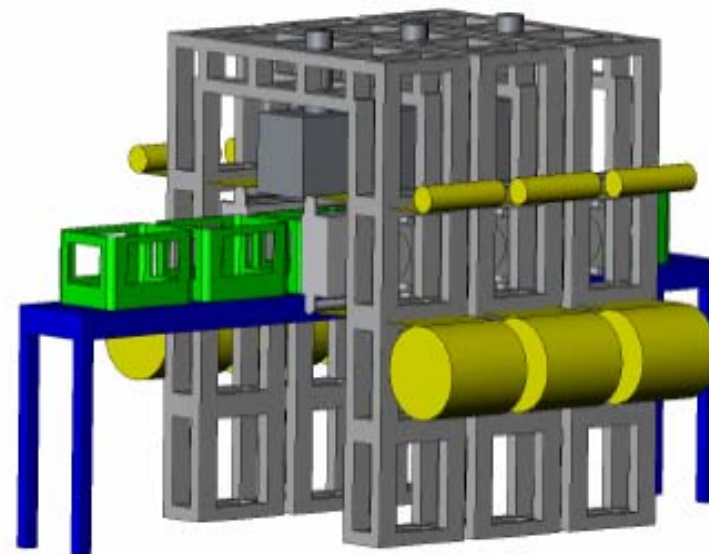

The Measurements of the Machine for the Application of the Film

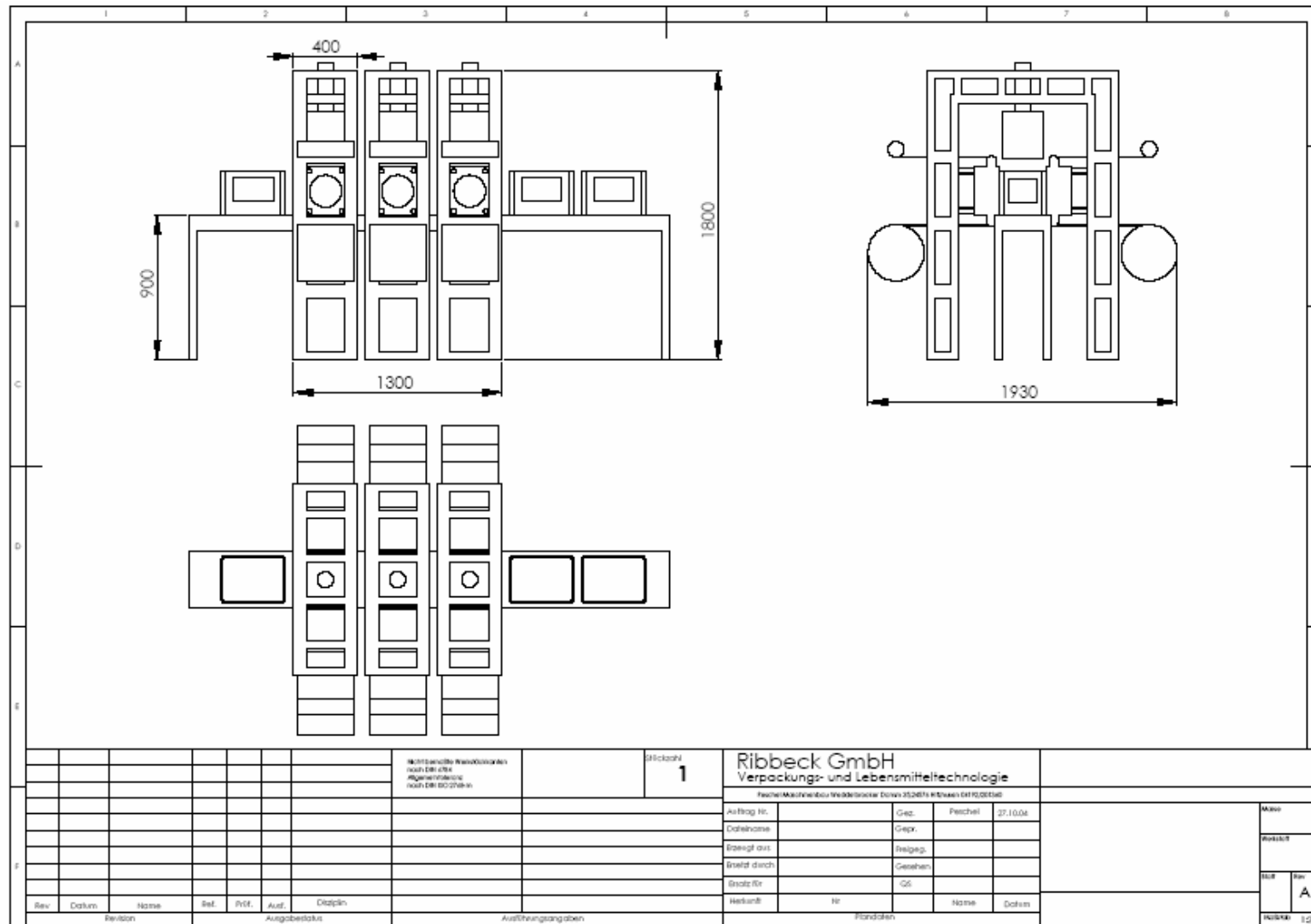

The Sealing Process

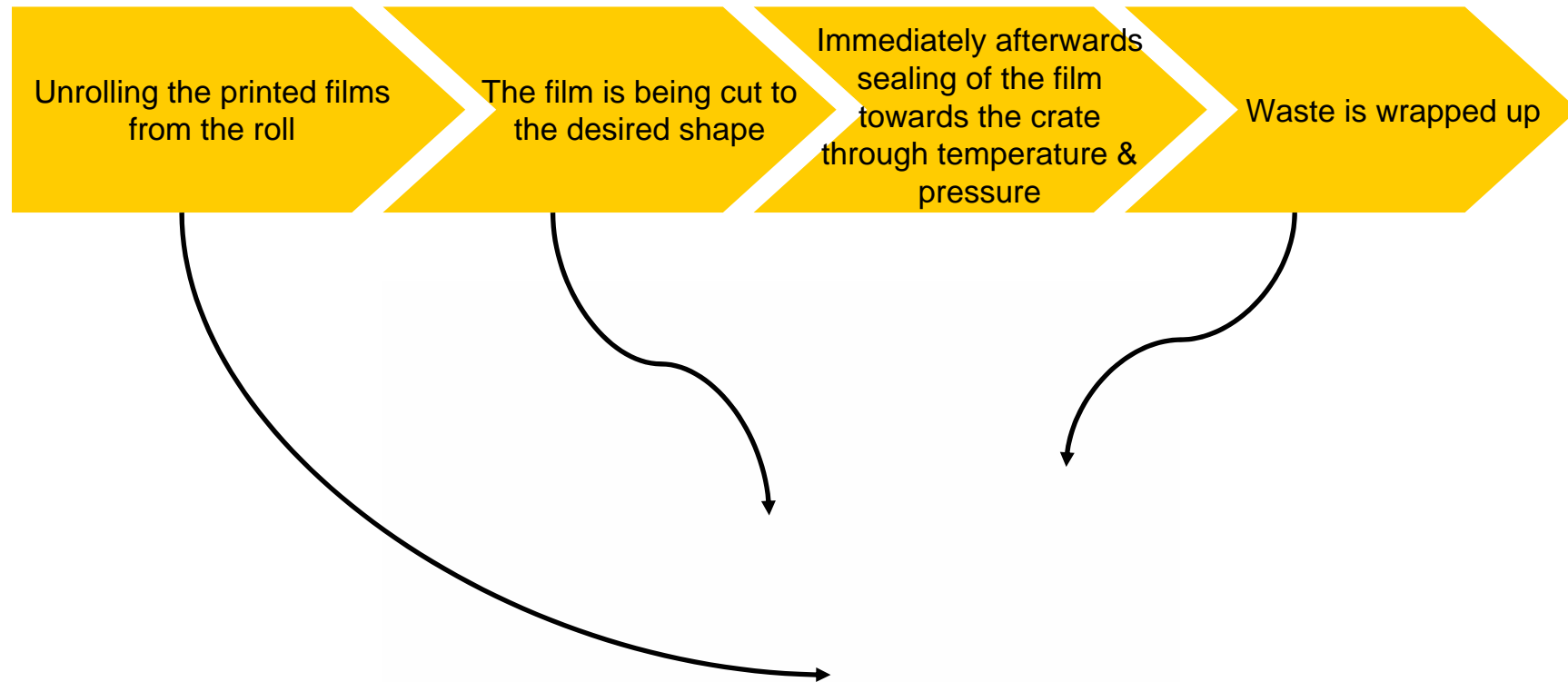

Film Sealing – The Test Application for Demonstrations

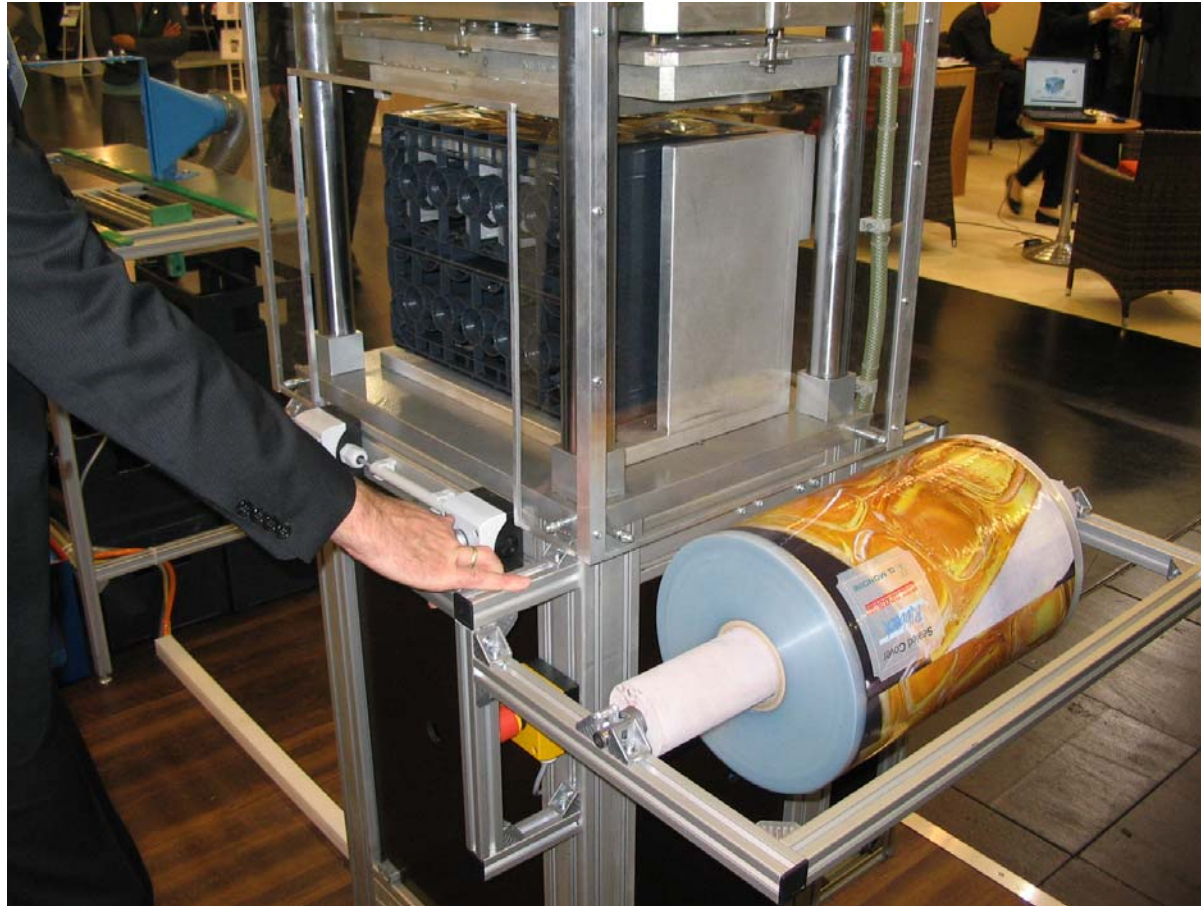

The Technique of Vacuuming the Film off

- Vacuuming the Film off the crate without residues
(no water needed!)
- Waste management without harm to the environment through recycling

Pictures of this technique are shown on the following pages

Film Vacuuming – The Test Application for Demonstrations

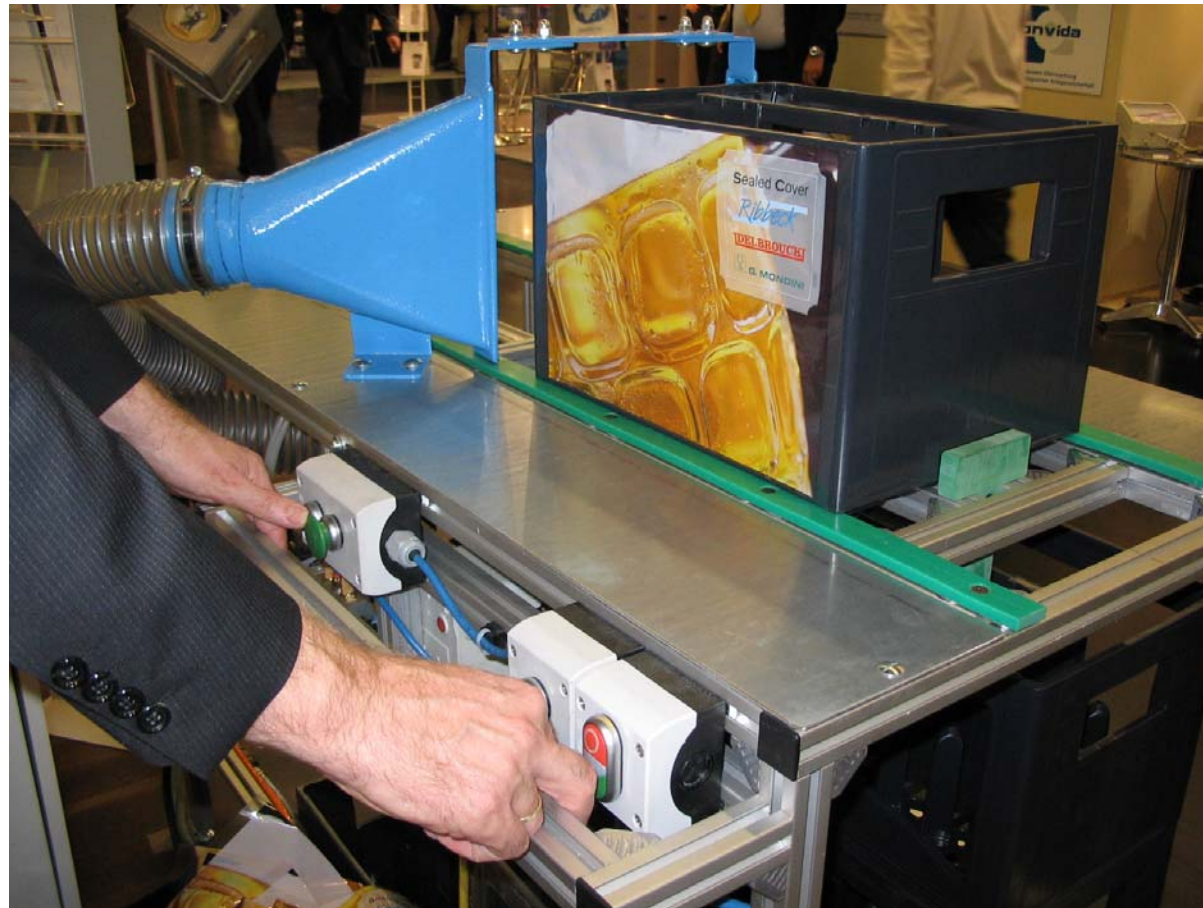

Film Vacuuming

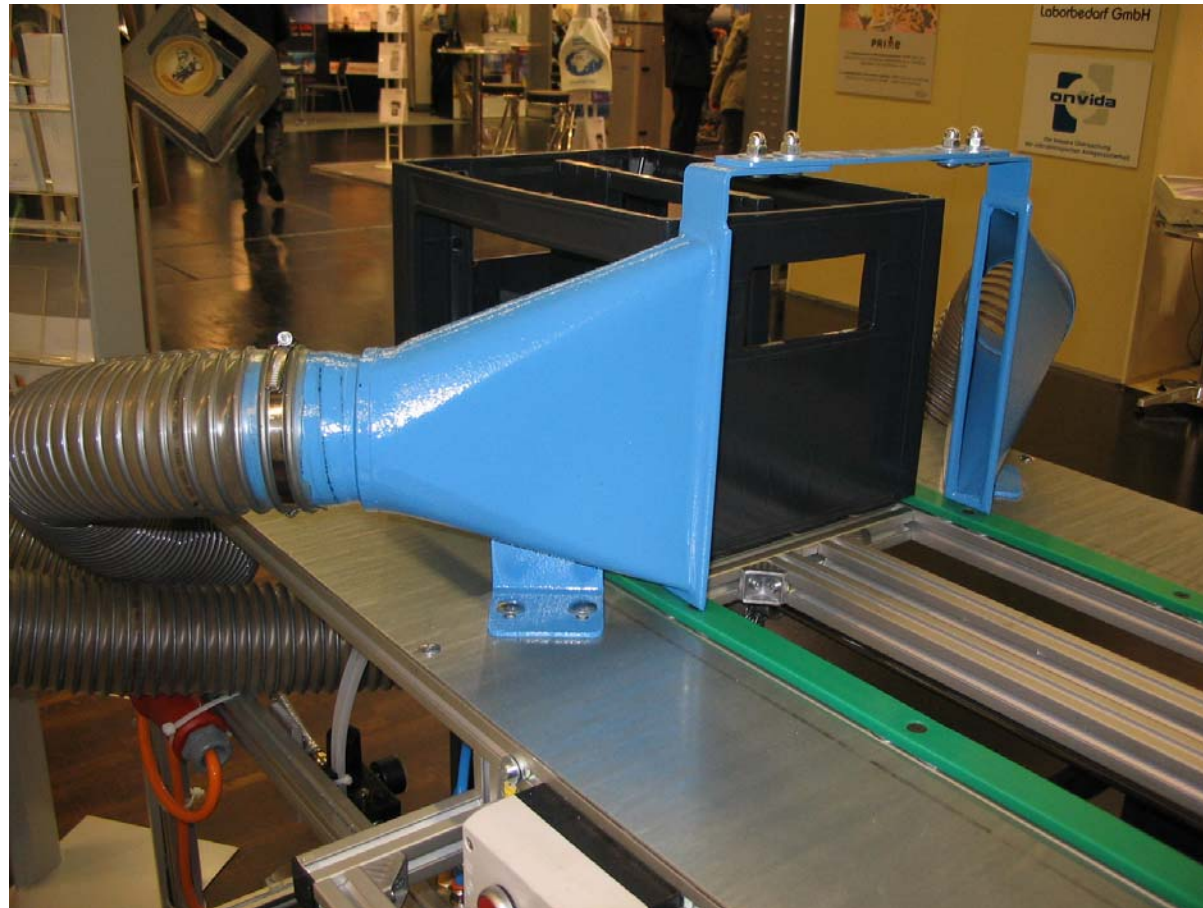

Costs

➤ Film (for two sides) ca. €0,04 to 0,07 depending on cut and layout

➤ Costs for the investment into a sealing machine:

ca. €150.000 for a machine with double sided sealing station

➤ Costs for the investment into a machine for the vacuuming:

max. €35.000 for one machine

Comparison of Films on Bottle Crates

	Sticker (Paper or Plastic)	Sleeve around the Crate	Sealed Film
One Cycle only	Weather influences the adhesiveness Print on the top (abrasion)	Weather influences the position of the sleeve	constant position abrasion resistant through print from the back
Several Cycles (up to 2 years)	The glue might be too strong	Not possible	Very good, film can always be taken off; but there may be dirt next to the sealing rips
Cut is not a rectangle but inclined or other	difficult	Not possible	Possible in many shapes, covering the print on the crate
EAN on the film	difficult	nur für EAN nicht möglich	Perfect
Add-Ons on the back of the Film	Not possible	Not possible	Add-ons need to be flat, then easy
Display crates	no	Possible if the crate has corner columns	Perfect
Future-proof	The cleaning with water is critical	no	This is the future
Look / Marketing	Not as good as in mould	cheap	Everything is possible
Price/ Costs/ Benefits	Uncertain positioning of the stickers does limits the design, therefore expensive. Film thickness ca. 150 µm	Looks cheap and is not flexible, therefore expensive	Allows a variety of designs, films with sealing layer are bulk goods Film thickness 60 to 100 µm

Consequences

ONE crate for different brands

A beverage producer having many different brands needs to take into account the following:

No sorting of crates after the return of the empties, therefore cost reduction:

Sorting of Crates	15 cent
Faster Return of the Invests and smaller Total Number of Crates needed	2 cent
Less Fix Costs for Storage Space, Insurance, Loss etc	1 cent
Marketing through the Crate, Actuality, Flexibility	x cent
Total Cost Reduction	> 20 cent

Costs for big film sealed onto the four sides of the crate in SC technique:

13 cent

Trend-Setting

- The change of consumer habits to buy single bottles or multipacks additionally to buying whole crates influences packaging needs. Beverage producers can solve this issue by combining:

- Dual-Tray System rented from the IFCO Pool

- Multi-Funktion-Crate of Delbrouck for 0,33 l and 0,5 l bottles

- Dual-Tray for fast return and second placings of multipacks and single bottles in the sales area

- Multi-Funktion-Crate, a pinol crate for single bottles, 4-packs and 6-packs, equipped with SC technique



**Our Goal:
Film Technique with Functions
On the Crate and on the Volume Pack**

DELBROUCKE